

IMPORTANT

Safety, Warning and Suggestions

1. Qualified electrician is required to install this product/s.
2. Please read instructions carefully before installation.
3. All wiring and installations should meet local, state and national electrical codes.
4. Install correct lamp type and wattage.

SWA Mount

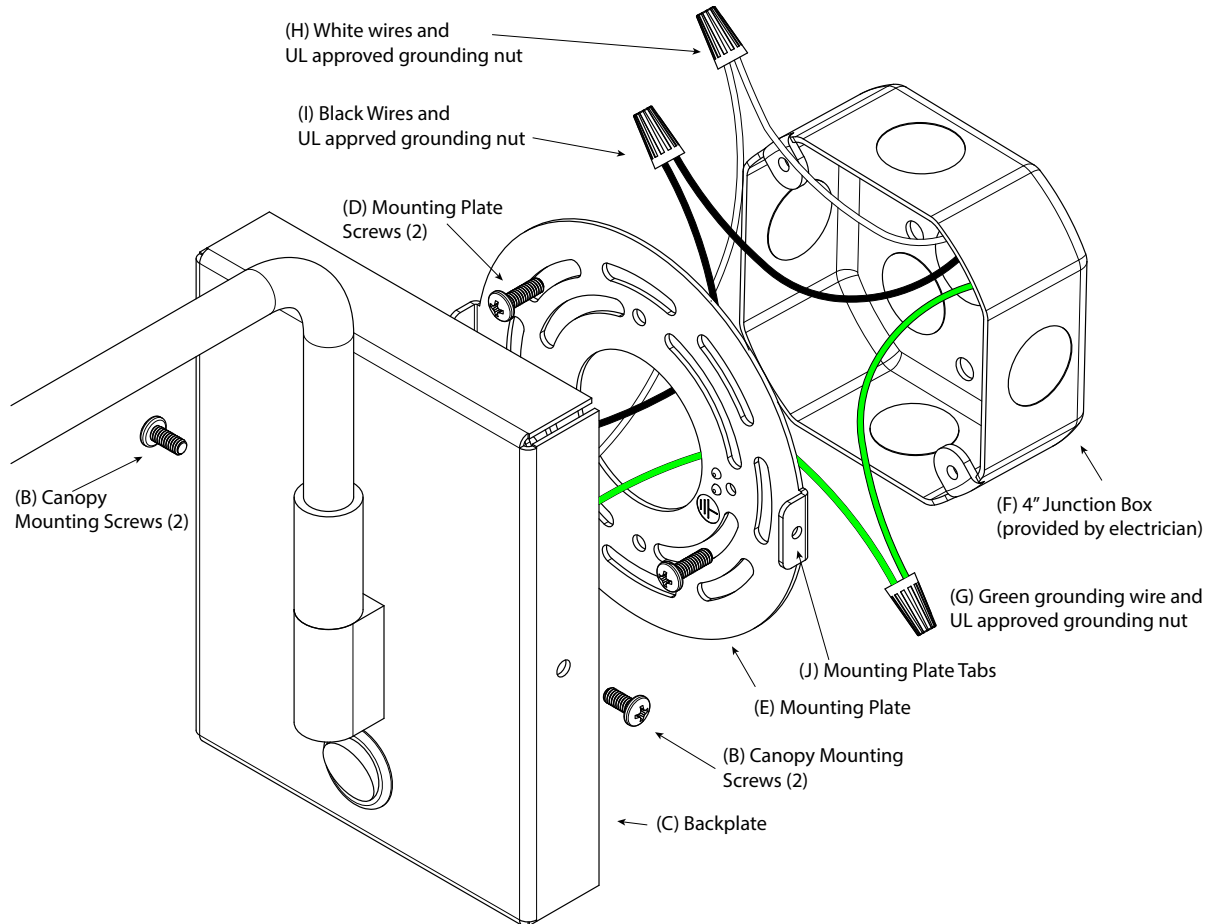

1. **Prior to installation, disconnect power at main electrical box.**
2. Feed lead wires from backplate (C) through mounting plate (E).
3. Make wiring connections. Green grounding wire to green grounding wire (G), white to white (H), black to black (I) using UL approved wirenuts. Carefully push wires into 4" octagon junction box (F).
4. Attach mounting plate (E) to 4" octagon junction box (F) with mounting plate screws (D) provided.
5. Attach backplate (C) to mounting plate tabs (J) using canopy screws (B).